

## Canvas Access For Parents

1. Student logs into Canvas. Select **Account** on left tab. Select **Settings**. Select **Pair with Observer**.

The screenshot shows the Canvas user interface. On the left is a dark sidebar with navigation icons. The main area is the 'Settings' page. The 'Profile' section contains fields for Full Name, Display Name, Sortable Name, Language, and Time Zone. The 'Web Services' section has a checkbox for sharing services with course members. The 'Registered Services' section is currently empty. The 'Other Services' section has a 'Click any service below to register:' label and a 'Google Drive' button. A red box highlights the 'Pair with Observer' button in the 'Other Services' section, with a red arrow pointing to it from the right.

Please write this code down which will be used in the Step 4.

The dialog box is titled 'Pair with Observer' and has a close button (X) in the top right. The text inside says: 'Share the following pairing code with an observer to allow them to connect with you. This code will expire seven days, or after one use.' Below the text is a text input field containing the code 'aBcD123'. There is an 'OK' button in the bottom right corner. A red arrow points from the right side of the screen towards the code field.

2. Parent goes to [www.scec.k12.in.us](http://www.scec.k12.in.us) Select **Students** Tab. Select **Canvas Access for Students**

The screenshot shows the website navigation menu for Scec.k12.in.us. The menu items are: Home, Parents, Students, Administration, Schools, Staff Resources, and About Us. The 'Students' item is highlighted with a red arrow. A sub-menu is open for 'Students', listing: ILEARN Practice Test for Students, Alumni, District Applications, RDS Course Planner, RDS Student Access, EPIC Student Login, and Canvas Access for Students. A red arrow points to the 'Canvas Access for Students' link. In the background, there is a banner for 'LIVE ST... lar School B... April 22, 2020' with a 'CLICK HERE' button and a play icon.

3. Parent selects **Parent of a Canvas User?**

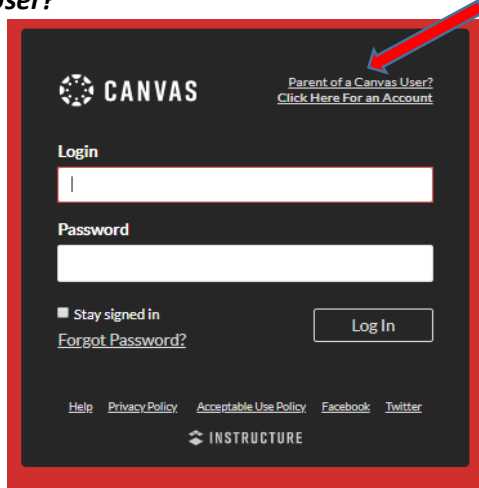

4. Enter in the below information along with Pairing Code from Step 1.

A screenshot of the "Parent Signup" form. The form has a white background with a dark border. It contains several input fields: "Your Name", "Your Email", "Password", "Re-enter Password", and "Student Pairing Code". There is a link "What is a pairing code?" next to the pairing code field. At the bottom, there are three buttons: "View Privacy Policy", "Cancel", and "Start Participating".

Your e-mail becomes your username for Canvas.

Please follow the below steps to add additional students to observe in Canvas.

5. Parents once you are in your Canvas account, Select the **Account** tab and then the **Settings** tab.

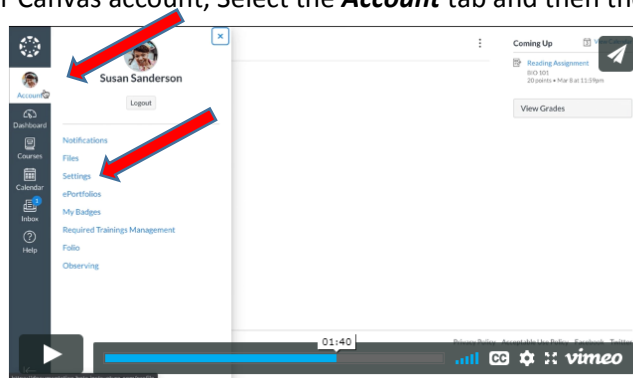

6. Then select the **Observing** Link. Add Pairing Code for other sibling(s) and then select **+ Student**.

